

EN

OPERATING MANUAL
DEHUMIDIFIER



Table of contents

Notes regarding the operating manual.....	1
Safety	2
Information about the device.....	4
Transport and storage.....	5
Assembly and installation.....	6
Operation	10
Errors and faults.....	13
Maintenance	15
Technical annex.....	19
Disposal	22

Notes regarding the operating manual

Symbols



Warning of electrical voltage

This symbol indicates dangers to the life and health of persons due to electrical voltage.



Warning!

This signal word indicates a hazard with an average risk level which, if not avoided, can result in serious injury or death.



Caution!

This signal word indicates a hazard with a low risk level which, if not avoided, can result in minor or moderate injury.

Note

This signal word indicates important information (e.g. material damage), but does not indicate hazards.



Info

Information marked with this symbol helps you to carry out your tasks quickly and safely.



Follow the manual

Information marked with this symbol indicates that the operating manual must be observed.

The current version of the operating manual can be found at:



TTK 172 ECO



<http://hub.trotec.com/?id=39523>

Legal notice

This release replaces all previous versions. No part of this publication may be reproduced without written permission from Trotec GmbH & Co. KG. The same applies for electronically processing, duplicating or spreading the publication. Subject to technical changes. All rights reserved. Trademarks are used without guarantee that they may be used freely and primarily following the spelling of the manufacturer. Product names are registered.

Changes to construction in the interests of constant improvements to the product, as well as changes to the shape and colour are reserved.

The scope of delivery may vary from product images. This document was created with all due care. Trotec GmbH & Co. KG accepts no liability whatsoever for possible mistakes or omissions.

© Trotec GmbH & Co. KG

Warranty and liability

The device complies with the fundamental health and safety requirements of the applicable EU regulations and was tested at the factory for perfect functionality multiple times.

However, if faults in the functionality occur and cannot be remedied with the measures in the chapter Errors and faults, please get in touch with your dealer or distributor.

When making a warranty claim, supply the device number (see the rear of the device).

When manufacturer's instructions or legal regulations have not been followed, or after unauthorised changes to the device are made, the manufacturer is not responsible for the resulting damages. Changes to the device or unauthorised replacement of individual parts can drastically impact the electrical safety of this product and will result in the loss of the warranty. Liability does not extend to damages to people or property caused by the device being used other than as described in the instructions in this operating manual. Subject to changes to technical design and model changes as part of constant development and product improvement without prior notice.

No liability is accepted for damages resulting from improper use. In such a case, any warranty claims will be voided also.

Safety

Read this manual carefully before starting or using the device. Always store the manual in the immediate vicinity of the device or its site of use!

- Do not use the device in potentially explosive rooms.
- Do not use the device in aggressive atmosphere.
- Set the device up in an upright and stable position.
- Let the device dry out after a wet clean. Do not operate it when wet.
- Do not use the device with wet or damp hands.
- Do not expose the device to directly squirting water.
- Never insert any objects or limbs into the device.
- Do not cover or transport the device during operation.
- Do not sit on the device.
- This appliance is not a toy! Keep away from children and animals. Do not leave the device unattended during operation.
- Check accessories and connection parts for possible damage prior to every use of the device. Do not use any defective devices or device parts.
- Ensure that all electric cables outside of the device are protected from damage (e.g. caused by animals). Never use the device if electric cables or the power connection are damaged!
- The electrical connection must correspond to the specifications in chapter Technical data.
- Insert the mains plug into a properly secured mains socket.
- Observe the device's power input, cable length and intended use when selecting extensions to the power cable. Completely unroll extension cables. Avoid electrical overload.
- Before carrying out maintenance, care or repair work on the device, remove the mains plug from the mains socket. Hold onto the mains plug while doing so.
- Switch the device off and disconnect the power cable from the mains socket when the device is not in use.
- Do not under any circumstances use the device if you detect damages on the mains plug or power cable. Defective power cables pose a serious health risk.
- Observe the storage and operating conditions (see chapter Technical data).
- Ensure that the air inlet and outlet are not obstructed.
- Ensure that the side of the device where the air inlet is found is kept free of dirt and loose objects.
- Only transport the device in an upright position with an emptied condensation tank or drain hose.
- Discharge the collected condensate before transport and storage. Do not drink it. Health hazard!

Intended use

Only use the device for drying and dehumidifying room air, while adhering to and following the technical data.

Intended use comprises:

- dehumidifying and drying:
 - living rooms, bedrooms, bathrooms and basements
 - laundries, holiday homes, camper vans, boats
- maintaining the dryness of:
 - storage spaces, archives, laboratories, garages
 - bathrooms, wash rooms, changing rooms etc.

Improper use

- Do not place the device on wet or flooded ground.
- Do not place any objects, e.g. clothing, on the device.
- Do not use the device outdoors.
- Any unauthorised modifications, alterations or structural changes to the device are forbidden.
- Any operation other than as described in this manual is prohibited. Non-observance renders all claims for liability and guarantee null and void.

Personnel qualifications

People who use this device must:

- be aware of the dangers that occur when working with electric devices in damp areas.
- have read and understood the operating manual, especially the Safety chapter.

Maintenance tasks which require the housing to be opened must only be carried out by specialist companies for cooling and air-conditioning or by Trotec.

Residual risks



Warning of electrical voltage

Work on the electrical components must only be carried out by an authorised specialist company!



Warning of electrical voltage

Before any work on the device, remove the mains plug from the mains socket!
Hold onto the mains plug while pulling the power cable out of the mains socket.



Warning!

Dangers can occur at the device when it is used by untrained people in an unprofessional or improper way! Observe the personnel qualifications!



Warning!

The device is not a toy and does not belong in the hands of children.



Warning!

Do not leave the packaging lying around. Children may use it as a dangerous toy.

Note

Do not operate the device without an inserted air filter! Without the air filter, the inside of the device will be heavily contaminated. This could reduce the performance and result in damage to the device.

Behaviour in the event of an emergency

1. In an emergency, disconnect the device from the mains feed-in: Switch the device off and disconnect the power cable from the mains socket. Hold onto the mains plug while doing so.
2. Do not reconnect a defective device to the mains.

Information about the device

Device description

The device uses the principle of condensation to automatically dehumidify rooms.

The fan sucks damp room air through the air inlet, the air filter, the evaporator and to the condenser located behind it. The air is cooled at the cold evaporator until it is below the dew point. Water vapour contained in the room air precipitates on the evaporator fins as condensation or rime. The dehumidified, cooled air is slightly warmed at the condenser and blown out again. The drier air thus conditioned mixes with the air in the room. The humidity in the room where the device is positioned is reduced as air constantly circulates through the device.

Depending on the air temperature and the relative humidity, the condensed water either drops continuously or only during the defrost phase through the integrated drain nozzle into the condensation tank below. It is fitted with a float to measure the filling level.

The device has a control panel for operating and controlling the functions.

Once the maximum filling level of the condensation tank is reached or in case the condensation tank is not installed correctly, the condensation tank indicator light (see chapter Operating elements) on the control panel is illuminated. The device switches off. The condensation tank indicator light only goes out again once the emptied condensation tank is reinserted.

Optionally, the condensed water can be drained by attaching a hose at the condensation connection.

The device can reduce the relative humidity of a room to approx. 30 %.

Because of the heat radiation generated during operation, the room temperature may rise slightly.

Device depiction

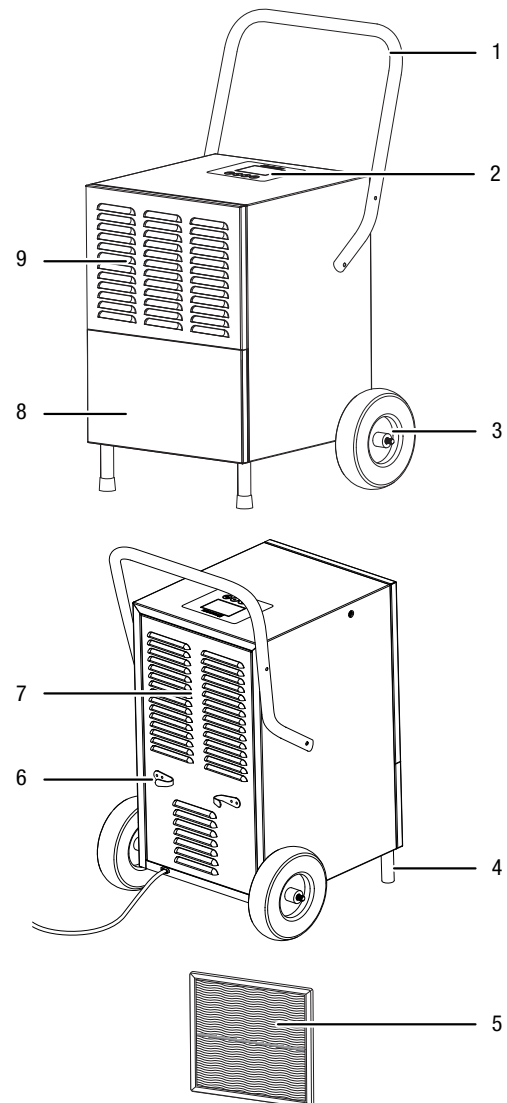

No.	Designation
1	Transport handle
2	Control panel
3	Transport wheel
4	Foot
5	Air filter
6	Power cable winder
7	Air outlet
8	Condensation tank (behind cover)
9	Air inlet with air filter

Transport and storage

Before transporting the device, proceed as follows:

- Switch off the device.
- Hold onto the mains plug while pulling the power cable out of the mains socket.
- Drain the remaining condensate from the device and the condensation drain hose (see chapter Maintenance).
- To make the device easier to transport, it is fitted with wheels.

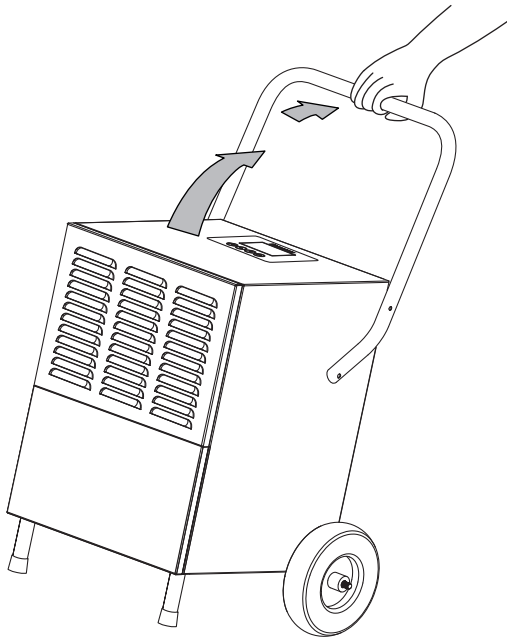

- Do not use the power cable to drag the device.
- Only wheel the device on a level and smooth surface.

After transporting the device, observe the following:

- Set up the device in an upright position after transport.
- Leave the device to rest for 12 - 24 hours, so the refrigerant can accumulate within the compressor.

Wait 12 - 24 hours before switching the device back on! Acting contrary might lead to compressor damage and a malfunctioning device. If so, any warranty claims will be voided.

Storage

Before storing the device, proceed as follows:

- Drain the remaining condensate from the device and the condensation drain hose (see chapter Maintenance).
- Empty and clean the condensation tank prior to storage.

When the device is not being used, observe the following storage conditions:

- dry and protected from frost and heat
- in an upright position where it is protected from dust and direct sunlight
- with a cover to protect it from invasive dust if necessary
- Place no further devices or objects on top of the device to prevent it from being damaged.

Assembly and installation

Scope of delivery

- 1x Device
- 1x Air filter
- 2x Wheel
- 1x Handle
- 1x Axis
- 2x Wire clip
- 2x Feet
- 6x Large screw
- 9x Small screw
- 1x Manual

Unpacking the device

1. Open the cardboard box and take the device out.
2. Completely remove the packaging.
3. Fully unwind the power cable. Make sure that the power cable is not damaged and that you do not damage it during unwinding.

Assembly

Mounting the wheels

Prior to initial start-up, the transport wheels and the axle must be attached to the device. To do so, please proceed as follows:

- ✓ The wheelset is ready for use.

1. Check the wheelset for completeness.

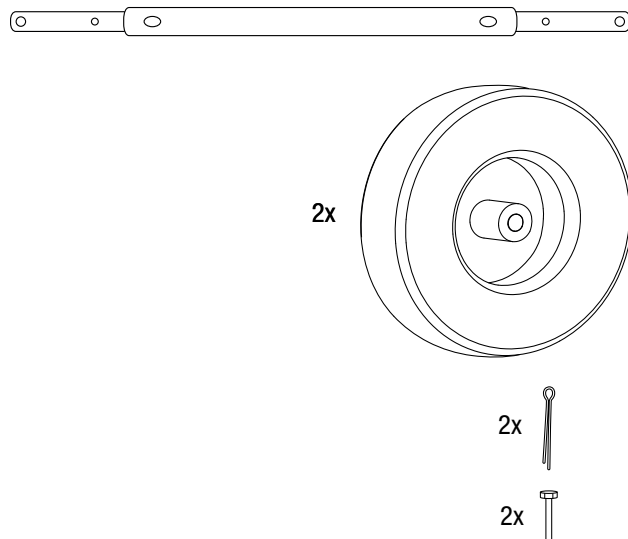

2. Use two screws to fasten the axle to the rear bottom side of the device.

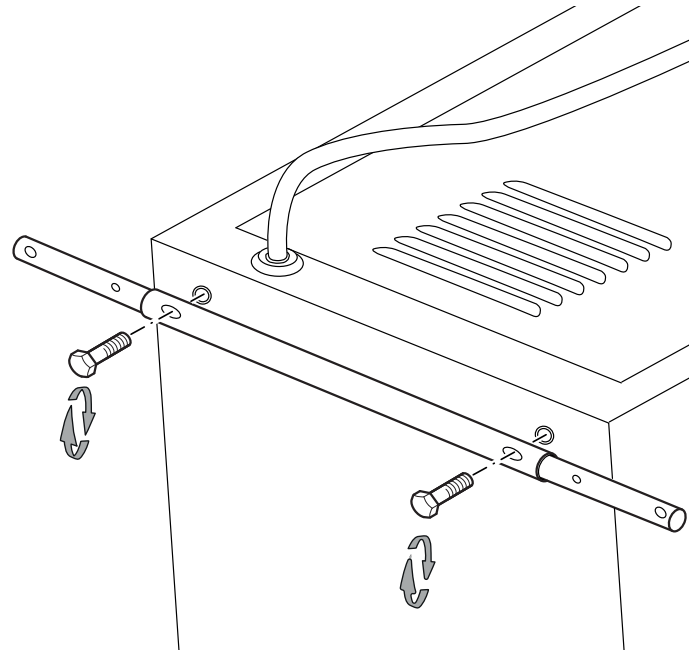

3. Attach the two wheels to the axle.

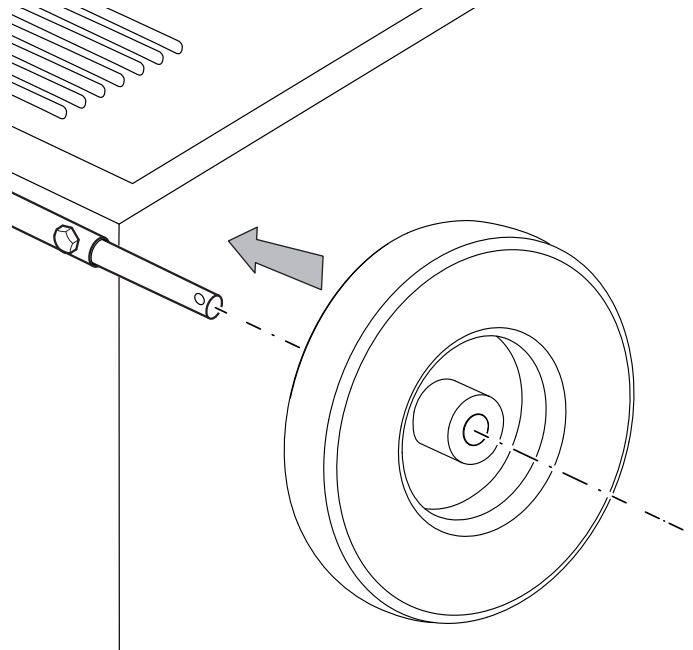

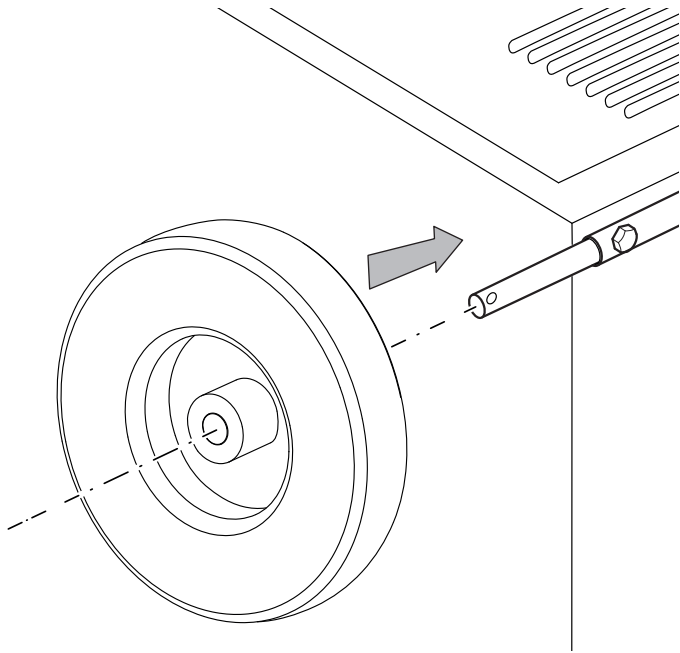

4. Guide the wire clips through the outer openings of the axle.

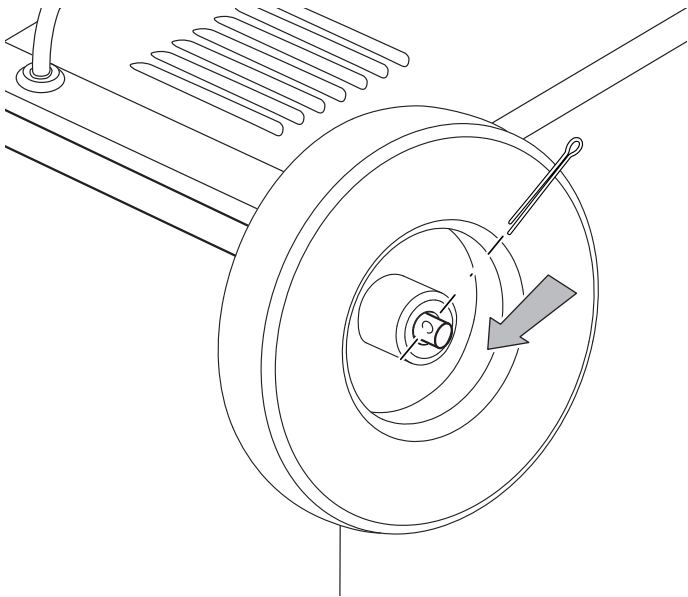

5. Use a pair of pliers to bend the outer end of the wire clip outwards.

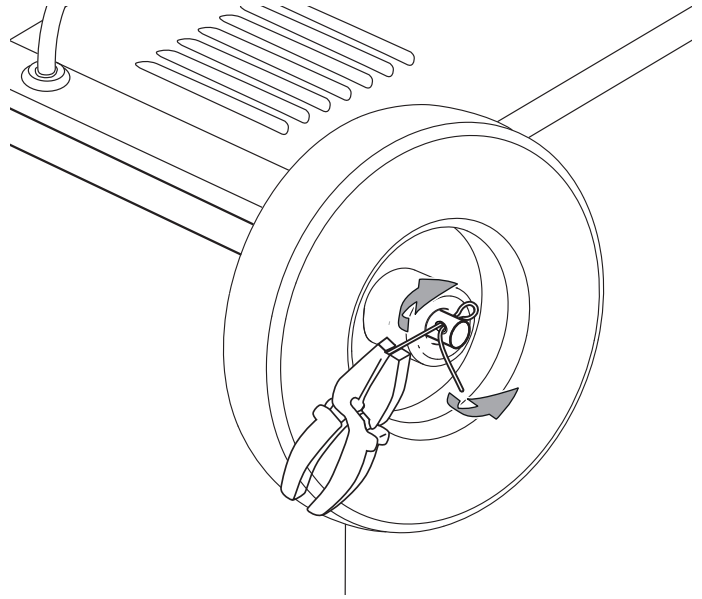

Mounting the feet

Prior to initial start-up, the two feet must be attached to the device. To do so, please proceed as follows:

1. Mount the two feet using 4 screws each to the front bottom side of the device.

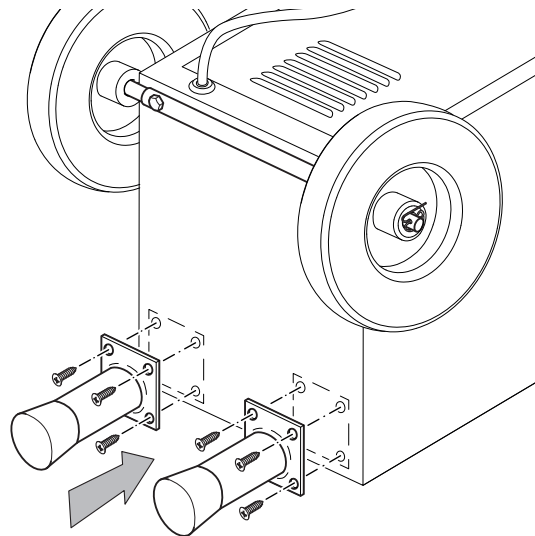

- After mounting the wheels and the feet, place the device in an upright position.
- Leave the device to rest for 12 - 24 hours, so the refrigerant can accumulate within the compressor. Wait 12 - 24 hours before switching the device back on! Acting contrary might lead to compressor damage and a malfunctioning device. If so, any warranty claims will be voided.

Mounting the transport handle

Prior to initial start-up, the transport handle must be attached to the device. To do so, please proceed as follows:

1. Mount the handle to both sides of the housing using four screws.

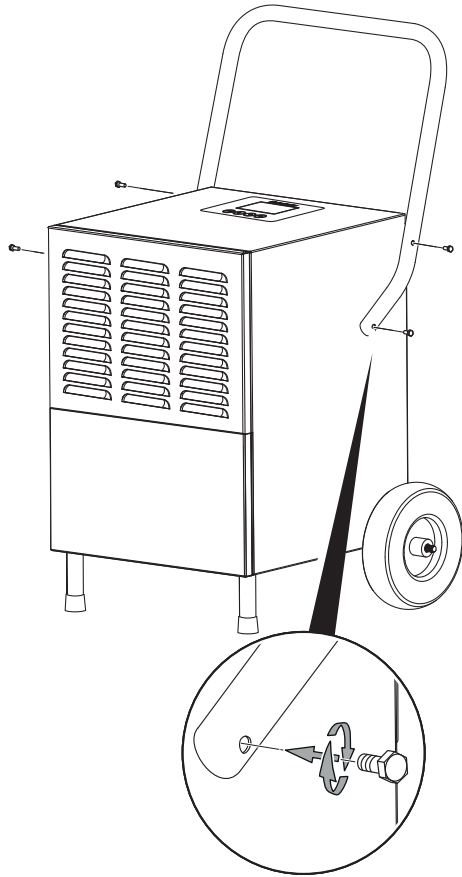

Start-up

When positioning the device, observe the minimum distance from walls or other objects as described in chapter Technical Data.

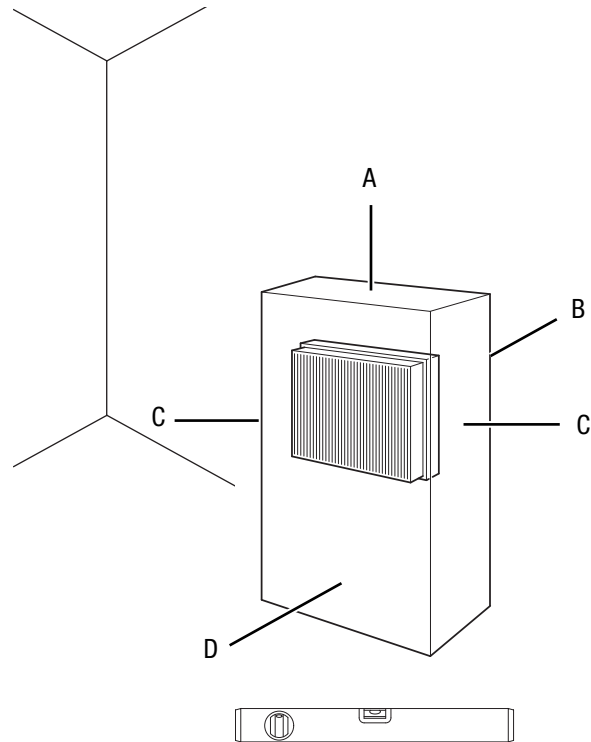

- Before restarting the device, check the condition of the power cable. If there are doubts as to the sound condition, contact the customer service.
- Set the device up in an upright and stable position.
- Do not create tripping hazards when laying the power cable or other electric cables, especially when positioning the device in the middle of the room. Use cable bridges.
- Make sure that extension cables are completely unrolled.
- When positioning the device, keep a sufficient distance to heat sources.
- Make sure that no curtains or other objects interfere with the air flow.
- When positioning the device, particularly in wet areas, secure it locally with an RCD (residual current device) which complies with the respective regulations.
- Do not incline the device by more than 45° when moving it around the room, otherwise the device could be damaged.

Inserting the air filter

Note

Do not operate the device without an inserted air filter! Without the air filter, the inside of the device will be heavily contaminated. This could reduce the performance and result in damage to the device.

- Make sure that the air filter is installed before switching the device on.

A.

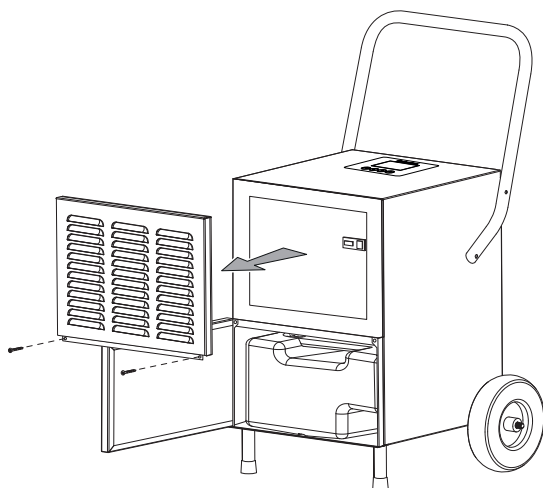

B.

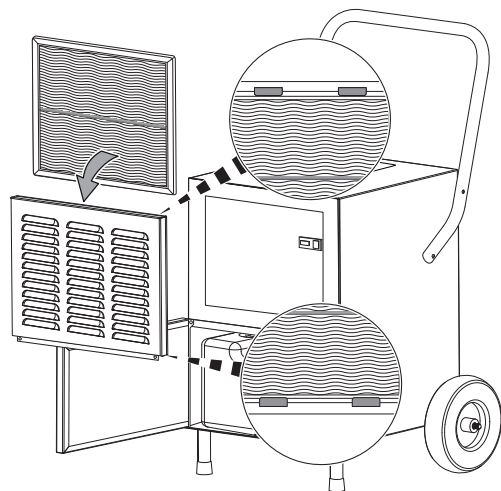

C.

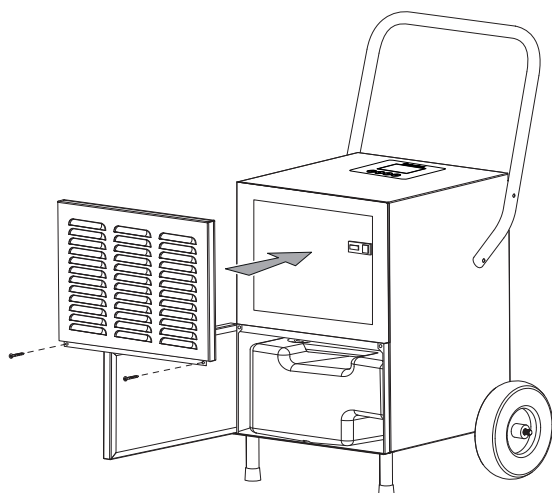

Inserting the condensation tank

- Ensure that the float inside the condensation tank is inserted correctly.
- Ensure that the condensation tank is empty and inserted correctly.

Connecting the power cable





- Insert the mains plug into a properly secured mains socket.

Operation

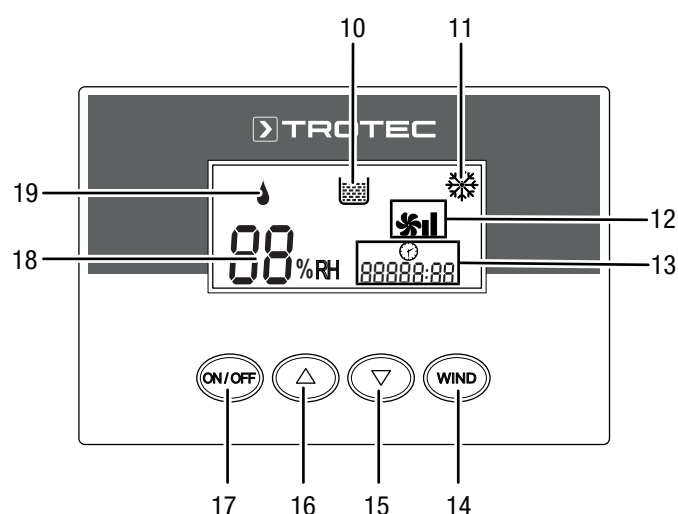
- Avoid open doors and windows.
- After being switched on, the device operates fully automatically.
- The compressor switches on approx. 3 minutes after the device has been switched on.
- The fan permanently runs in dehumidification mode until the set nominal value is reached. The fan keeps running for approx. 3 minutes and then switches off.

Operating elements



No.	Designation	Meaning
10	Condensation tank full indication	Is displayed when the condensation tank is full or not installed correctly
11	Defrost indication	Is displayed when automatic defrosting is in progress
12	Fan speed indication	Indication of the fan speed:  = low  = high
13	Operating hours counter indication	Indication of operating hours: 5 digits for hours 2 digits for minutes
14	WIND button	Setting the fan speed:  = low  = high
15	Arrow buttons	Decreasing the desired relative room humidity
16		Increasing the desired relative room humidity
17	ON/OFF button	Power button: Switches the device on or off
18	Room humidity / fault diagnosis indication	Indicates the current relative room humidity Indicates the desired relative room humidity during setting Indicates message regarding fault diagnosis (see chapter Error codes).
19	Dehumidification indication	Is displayed during dehumidification and flashes if the compressor is not working

Switching the device on

Once you have completely installed the device as described in the Start-up chapter, you can switch it on.

Note

Only use the device in an upright position, otherwise the compressor could be damaged.

1. Press the *ON/OFF* button (17).

⇒ The device starts to dehumidify.

Setting the operating mode

Setting the desired relative room humidity

You can change the desired relative room humidity at any time.

1. Press the arrow buttons (15, 16) to set the desired relative room humidity. Setting is possible in the range between 10 % and 95 % in steps of 1 %.

⇒ If you press and hold the arrow buttons, the setting changes more rapidly.

⇒ The desired relative room humidity is shown on the *room humidity / fault diagnosis* indication (18) for approx. 10 seconds. Then the current relative room humidity is displayed again.

Setting the fan speed

You can choose between low and high fan speed at any time.

1. Press the *WIND* button (14) to select either low or high fan speed.

⇒ The selected fan speed is indicated on the *fan speed* indication (12).

Dehumidification

The device keeps running until reaching the desired relative room humidity. Then the compressor switches off and the fan keeps running and switches off with a delay. Once the desired relative room humidity is exceeded, the compressor and ventilation switch back on.

The desired relative room humidity can be set within a setting range from 10 % to 95 % in steps of 1 % at any time.



Info

The effective dehumidification range lies between 30 % and 80 %, even if the device allows for relative humidity levels between 10 % and 95 %.

You can choose between low and high fan speed at any time.

Memory function

During short power failures, the device memorises the desired relative room humidity and the selected fan speed. Once the power supply has been restored, the device will start automatically.

Auto stop function

If the water tank is full, not inserted correctly or the desired relative room humidity has been reached, the device will stop automatically. The fan keeps running for approx. 3 minutes and then switches off.

Operating hours counter

The device is equipped with an operating hours counter (13). The minute display has two digits and the hour display has five digits.

Operation with hose attached to the condensation connection

For continuous operation or unattended dehumidification, please connect a suitable condensation drain hose to the device.

- ✓ A suitable hose (diameter: 13 mm) is ready for use.
- ✓ The device is switched off.

1. Open the front cover.

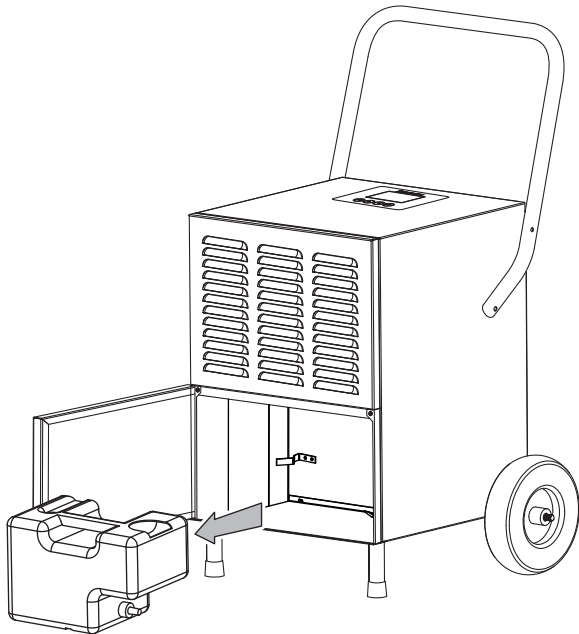

2. Remove the condensation tank.

3. Guide the condensation drain hose through the hole in the device's bottom panel.

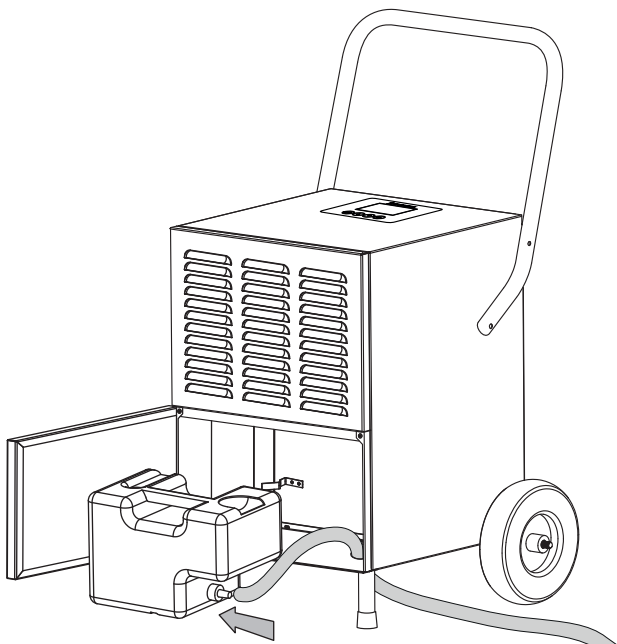

4. Push one end of the hose onto the hose connection at the condensation tank.

5. Refit the condensation tank into the device.

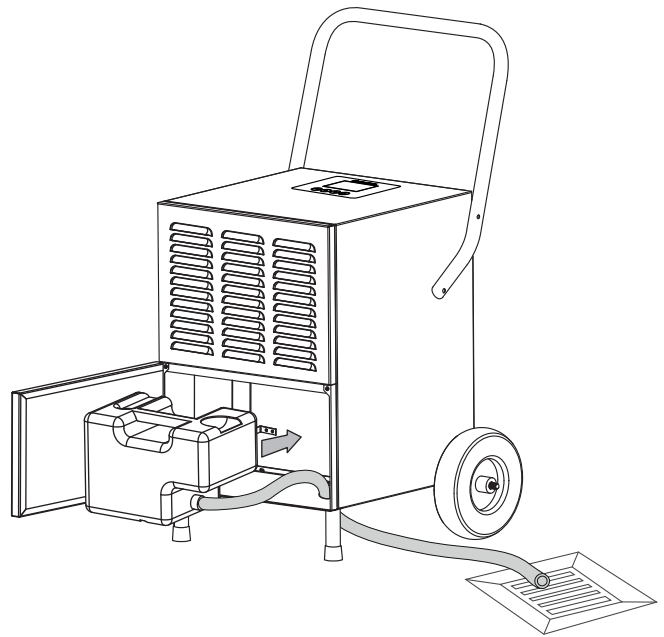

6. Guide the other hose end to a suitable drain or sufficiently dimensioned collection container. Please observe that the hose must not be kinked.

Remove the hose if you want to collect the condensate in the condensation tank again. Allow the hose to dry prior to storage. The hose can be connected in any operating mode for continuous operation.

Automatic defrost

At low ambient temperatures, ice may form at the evaporator during dehumidification. The device will then carry out an automatic defrost. Dehumidification is briefly interrupted during defrosting. The fan keeps running.

The duration of the defrost process can vary. Do **not** switch off the device during automatic defrost. Do **not** remove the mains plug from the mains socket.

The *defrost* (11) and *fan speed* (12) indications are illuminated during automatic defrosting.

Shutdown



Warning of electrical voltage

Do not touch the mains plug with wet or damp hands.

- Switch off the device.
- Hold onto the mains plug while pulling the power cable out of the mains socket.
- If necessary, remove the condensation drain hose and any residual fluid from it.
- Empty the condensation tank, if need be.
- Clean the device according to the Maintenance chapter.
- Store the device according to the Storage chapter.

Errors and faults

The device has been checked for proper functioning several times during production. If malfunctions occur nonetheless, check the device according to the following list.

The device does not start:

- Check the power connection.
- Check the power cable and mains plug for damages.
- Check the on-site fusing.
- Check the filling level of the condensation tank and empty it if necessary. The *condensation tank full* indication (10) and the *room humidity / fault diagnosis* indication (18) with the **FU** error message must not light up.
- Check the condensation tank for correct seating.
- Wait for 10 minutes before restarting the device. If the device is not starting, have the electrics checked by a specialist company or by Trotec.

The device is running, but no condensate forms:

- Check the float in the condensation tank for dirt. If necessary, clean the condensation tank. The float must be able to move freely.
- Check the room temperature. Observe the device's permissible operating range according to the technical data.
- Ensure that the relative room humidity complies with the technical data.
- Check the preselected desired room humidity level. The relative humidity in the room must be above the selected range. If necessary, reduce the preselected desired room humidity.
- Check the air filter for dirt. If necessary, clean or replace the air filter.
- From the outside, check the condenser for dirt (see chapter Maintenance). If the condenser is dirty, have it cleaned by a specialist company or by Trotec.
- The device might carry out an automatic defrost. During automatic defrost, the device does not dehumidify.

The device is loud or vibrates:

- Check whether the device is set up in a stable and upright position.

Condensate is leaking:

- Check the device for leaks.

The compressor does not start:

- Check the room temperature. Observe the device's permissible operating range according to the technical data.
- Ensure that the relative room humidity complies with the technical data.
- Check the preselected desired room humidity level. The relative humidity in the room must be above the selected range. If necessary, reduce the preselected desired room humidity.
- Check whether the overheating protection of the compressor has tripped. Disconnect the device from the mains and let it cool down for approx. 10 minutes before reconnecting it.
- The device might carry out an automatic defrost. During automatic defrost, the device does not dehumidify.

The device gets very warm, is loud or loses power:

- Check the air inlets and air filter for dirt. Remove external dirt.
- From the outside, check the device for dirt (see chapter Maintenance). If the inside of the device is dirty, have it cleaned by a specialist company for cooling and air-conditioning or by Trotec.

Note

Wait for at least 3 minutes after maintenance and repair work. Only then switch the device back on.

Your device still does not operate correctly after these checks?

Please contact the customer service. If necessary, bring the device to a specialist company for cooling and air-conditioning or to Trotec for repair.

Error codes

The following error messages can be displayed on the *room humidity / fault diagnosis* indication (18):

Error message	Cause	Remedy
E1	Fault at coil sensor	The coil sensor must be replaced. Please contact the customer service. If necessary, bring the device to a specialist company for cooling and air-conditioning for repair.
E2	Fault at humidity sensor	The humidity sensor must be replaced. Please contact the customer service. If necessary, bring the device to a specialist company for cooling and air-conditioning for repair.
E3	Fault at temperature sensor	The temperature sensor must be replaced. Please contact the customer service. If necessary, bring the device to a specialist company for cooling and air-conditioning for repair.
E4	Hot/cold system error	Please contact the customer service. If necessary, bring the device to a specialist company for cooling and air-conditioning for repair.
E5	Excessive room temperature	Check whether the room temperature complies with the technical data. The device starts again when the room temperature complies with the specified data.
FU	Condensation tank full	Empty the condensation tank (see chapter Emptying the condensation tank).
	Condensation tank not installed correctly	Check the condensation tank for correct seating.

Maintenance

Maintenance intervals

Maintenance and care interval	before every start-up	as needed	at least every 2 weeks	at least every 4 weeks	at least every 6 months	at least annually
Empty condensation tank and drain hose		X				
Check the air inlets and outlets for dirt and foreign objects and clean if necessary	X			X		
Clean the exterior		X				X
Visually check the inside of the device for dirt		X				X
Check the air filter for dirt and foreign objects and clean or replace if necessary	X		X			
Replace air filter					X	
Check for damage	X					
Check the attachment screws		X				X
Test run						X

Maintenance and care log

Device type:

Device number:

Maintenance and care interval	1	2	3	4	5	6	7	8	9	10	11	12	13	14	15	16
Empty condensation tank and drain hose																
Check the air inlets and outlets for dirt and foreign objects and clean if necessary																
Clean the exterior																
Visually check the inside of the device for dirt																
Check the air filter for dirt and foreign objects and clean or replace if necessary																
Replace air filter																
Check for damage																
Check the attachment screws																
Test run																
Remarks:																

1. Date: Signature:	2. Date: Signature:	3. Date: Signature:	4. Date: Signature:
5. Date: Signature:	6. Date: Signature:	7. Date: Signature:	8. Date: Signature:
9. Date: Signature:	10. Date: Signature:	11. Date: Signature:	12. Date: Signature:
13. Date: Signature:	14. Date: Signature:	15. Date: Signature:	16. Date: Signature:

Activities required before starting maintenance



Warning of electrical voltage

Do not touch the mains plug with wet or damp hands.

- Switch off the device.
- Hold onto the mains plug while pulling the power cable out of the mains socket.



Warning of electrical voltage

Maintenance tasks which require the housing to be opened must only be carried out by authorised specialist companies or by Trotec.

Cleaning the housing

Clean the device with a soft, damp and lint-free cloth. Ensure that no moisture enters the housing. Protect electrical components from moisture. Do not use any aggressive cleaning agents such as cleaning sprays, solvents, alcohol-based or abrasive cleaners to dampen the cloth.

Visual inspection of the inside of the device for dirt

1. Remove the air filter.
2. Use a torch to illuminate the openings of the device.
3. Check the inside of the device for dirt.
4. If you see a thick layer of dust, have the inside of the device cleaned by a specialist company for cooling and air-conditioning or by Trotec.
5. Put the air filter back in.

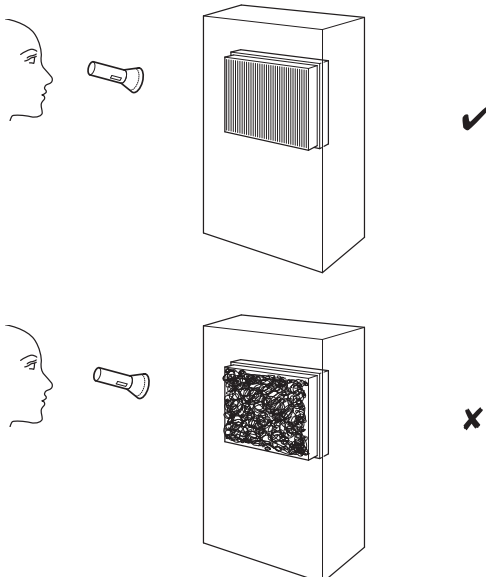

Cleaning the air filter

Note

Ensure that the air filter is not worn or damaged. The corners and edges of the air filter must not be deformed or rounded. Before reinserting the air filter, make sure that it is undamaged and dry!

The air filter has to be cleaned as soon as it is dirty. This is brought to light e.g. by a reduced capacity (see chapter Errors and faults).

1. Remove the two screws from the bottom of the air inlet.

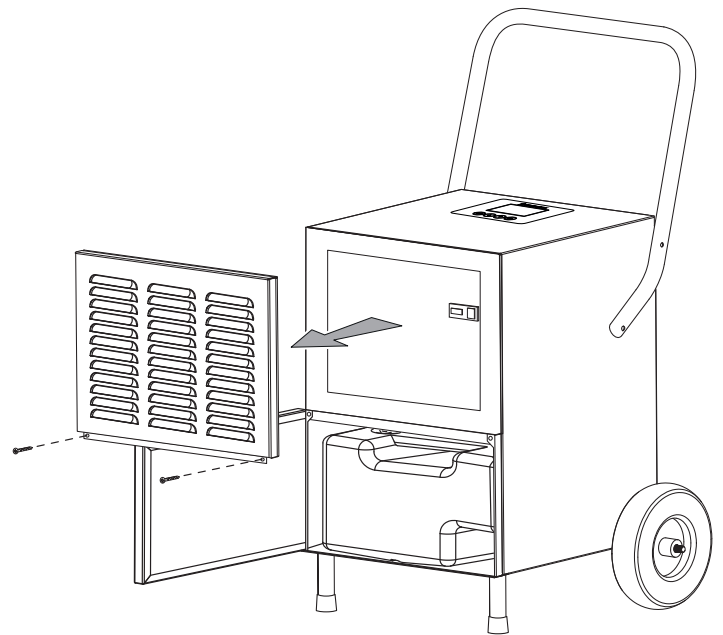

Refrigerant circuit

- The entire refrigerant circuit is a maintenance-free, hermetically sealed system and may only be maintained or repaired by specialist companies for cooling and air-conditioning or by Trotec.

2. Remove the air filter from the device.

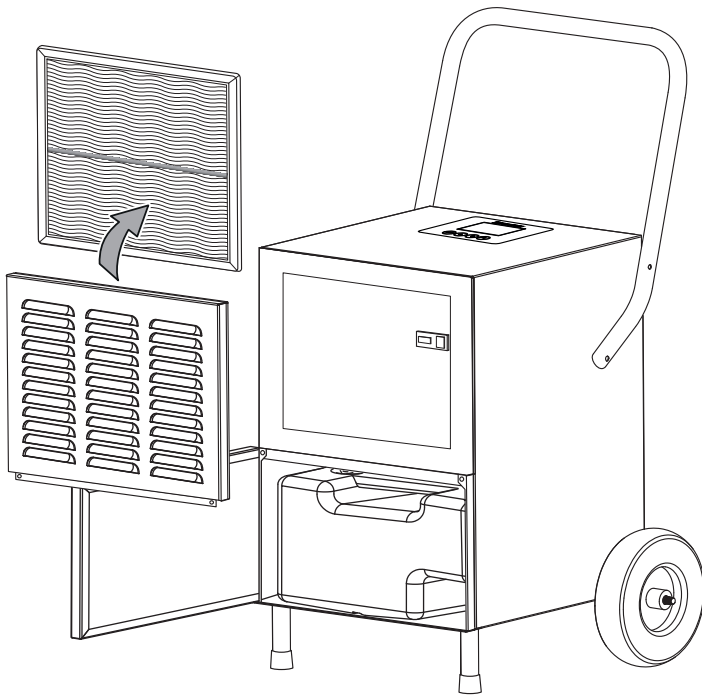

3. Clean the filter using a slightly damp, soft, lint-free cloth. If the filter is heavily contaminated, clean it with warm water mixed with a neutral cleaning agent.

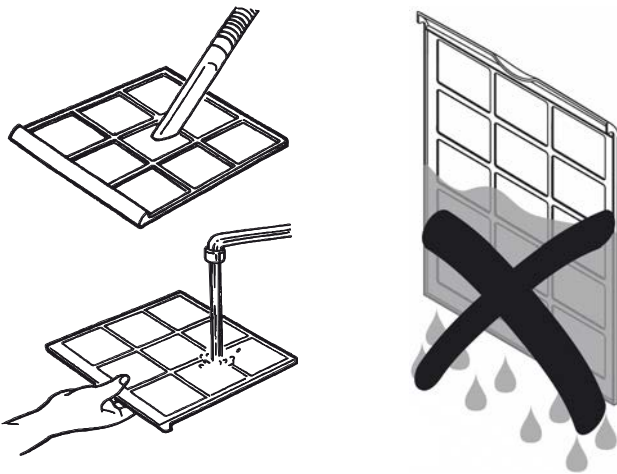

4. Allow the filter to dry completely. Do not insert a wet filter into the device!

5. Reinsert the air filter into the device.

⇒ The air filter must be seated below the depicted brackets.

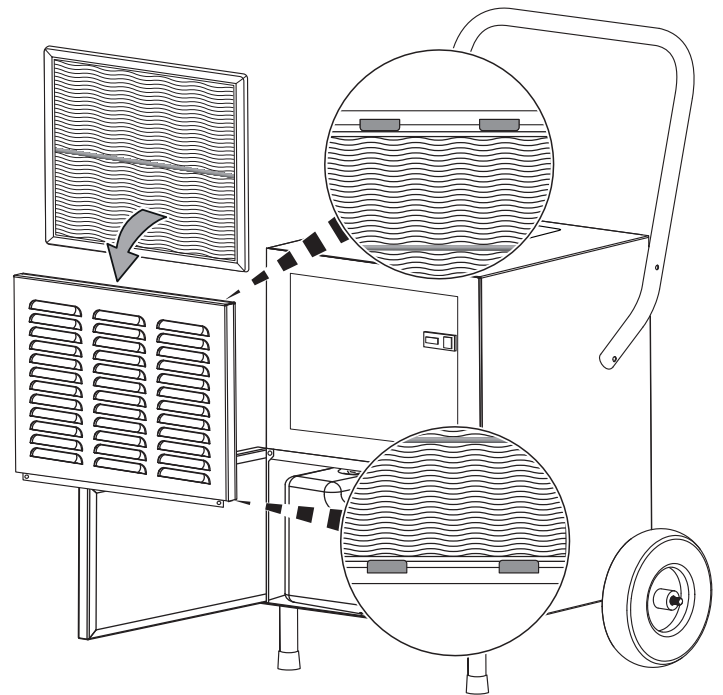

6. Fasten the two screws at the bottom of the air inlet.

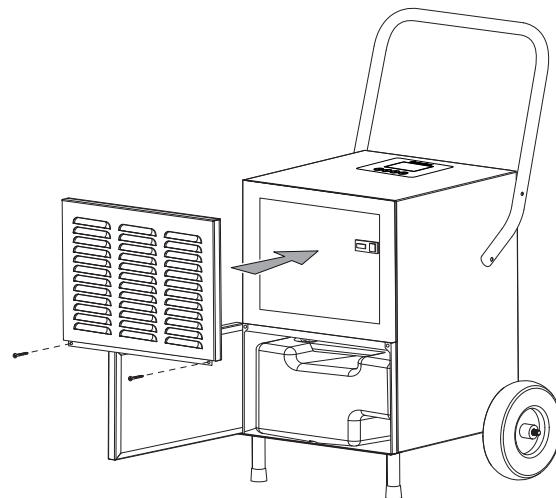

Emptying the condensation tank

If the condensation tank is full or not installed correctly, the *condensation tank full* indication (10) will light up on the control panel and the letters **FU** will appear on the *room humidity / fault diagnosis* indication (18). The compressor and fan will switch off.

1. Take the condensation tank out of the device.

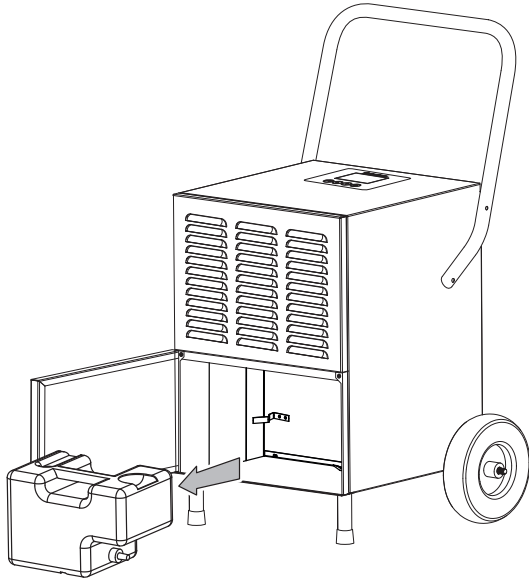

2. Empty the condensation tank over a drain or sink.
3. Rinse the tank with clear water. Clean the tank regularly using a mild cleaning agent (no detergent!).
4. Refit the condensation tank into the device.
Make sure not to damage the float when inserting or removing the condensation tank.
In doing so, make sure that the float is positioned correctly.
In doing so, make sure that the condensation tank is inserted correctly, for otherwise the device cannot be switched back on.

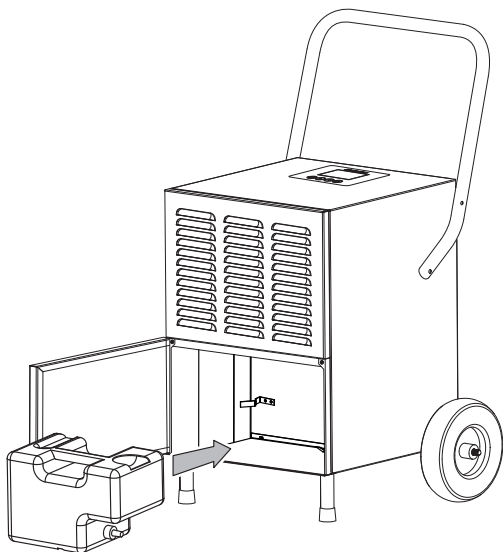

Activities required after maintenance

If you want to continue using the device:

- Leave the device to rest for 12 - 24 hours, so the refrigerant can accumulate within the compressor. Wait 12 - 24 hours before switching the device back on! Acting contrary might lead to compressor damage and a malfunctioning device. If so, any warranty claims will be voided.
- Reconnect the device to the mains.

If you do not intend to use the device for a considerable time:

- Store the device according to the Storage chapter.

Technical annex

Technical data

Parameter	Value
Model	TTK 172 ECO
Max. dehumidification performance	55 l / 24 h
Dehumidification performance @ 30 °C and 80 % RH	50 l / 24 h
Air volume flow	350 m³/h
Ambient temperature	5 °C to 35 °C
Operating range relative humidity	30 % to 80 % RH
Mains connection	1/N/PE ~ 220 – 240 V/ 50 Hz
Power input	1.15 kW
Nominal current	5 A
Refrigerant	R470C
Amount of refrigerant	410 g
Condensation tank capacity	7 l
Sound pressure level (1 m distance)	55 dB(A)
Dimensions (length x width x height)	543 x 315 x 1100 (mm)
Minimum distance to walls and other objects	A: top: 50 cm B: rear: 50 cm C: side: 30 cm D: front: 50 cm
Weight	29 kg

Wiring diagram

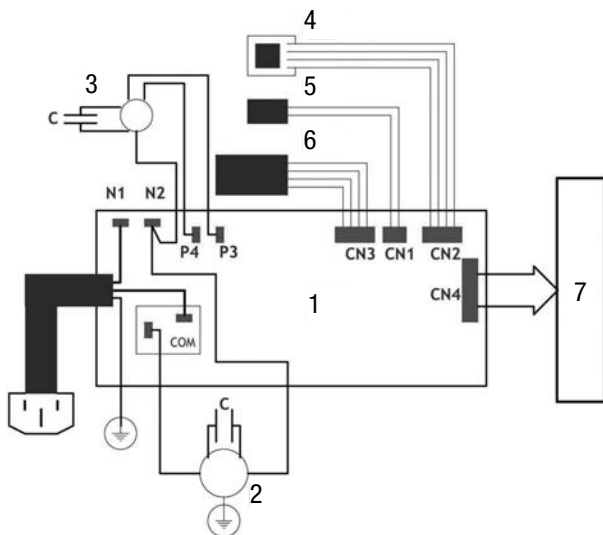

1	Mainboard	2	Compressor
3	Fan motor	4	Humidity sensor
5	Temperature sensor	6	Light barrier
7	To the display board		

Spare parts drawing and list



Info

The position numbers of the spare parts differ from those describing the positions of other parts mentioned in this operating manual.

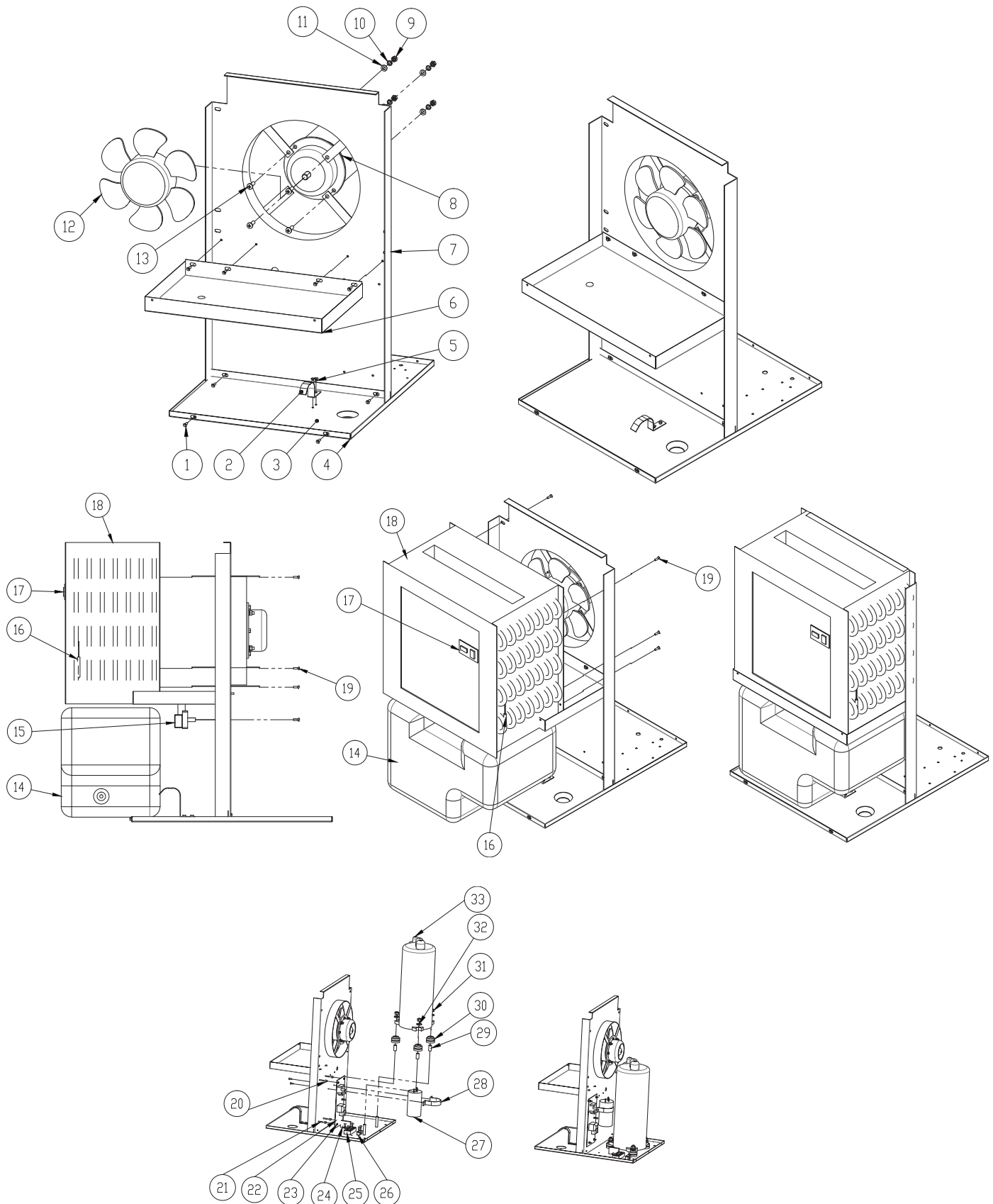

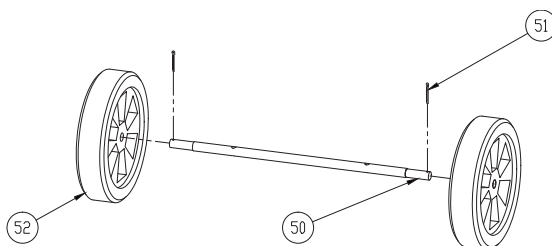
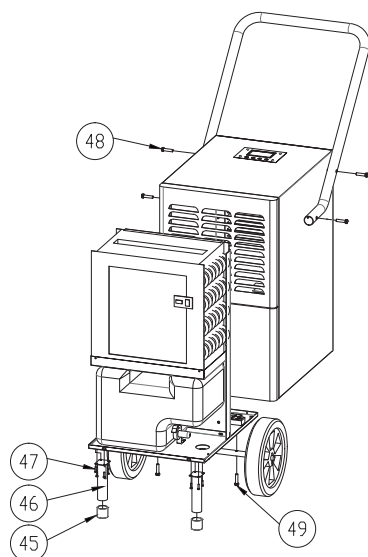
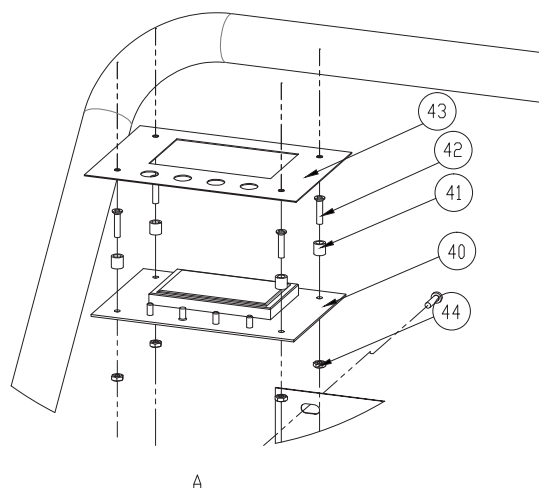
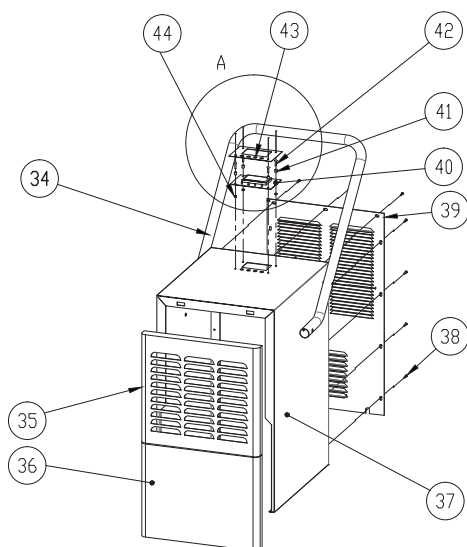

No.	Spare part	No.	Spare part	No.	Spare part
1	Self-tapping screws M3*12	19	Self-tapping screws M3*12	37	Machine body shell
2	Water tank fixed buckle	20	Circuit board insulation circle	38	Self-tapping screws M3*12
3	Water tank subplate	21	M3*20 screws for circuit board	39	Back board
4	Pedestal	22	Circuit board	40	Display board
5	Self-tapping screws M3*12	23	M3 screw nuts for circuit board	41	Circuit board insulation circle
6	Water tray	24	Fan motor capacitor	42	M3*20 screws for display board
7	Median septum	25	Terminal Blocks	43	Display label
8	Fan motor	26	Electric wire clasp	44	M3 screw nuts for display board
9	M5 screw nuts for fan motor	27	Compressor capacitor	45	Locking plug
10	M5 Spring washer for fan motor	28	Compressor capacitor fixed plate	46	Supporting leg
11	M5 gaskets for fan motor	29	Compressor fixed sleeve	47	Self-tapping screws M3*12 to fix bottom body shell
12	Fan blades	30	Compressor cushion	48	M3*25 screw
13	M5*20 screws for fan motor	31	M8 screw nuts for compressor	49	M3*35 screw
14	Water tank	32	M8 gasket for compressor	50	Wheel axle
15	Water level sensor	33	Compressor	51	Ø3 cotter pin
16	Temperature sensor	34	The short handle	52	Wheel
17	Humidity sensor	35	Upper front board		
18	Condensator & Evaporater	36	Bottom front board		

Disposal



■ In the European Union, electronic equipment must not be treated as domestic waste, but must be disposed of professionally in accordance with Directive 2012/19/EU of the European Parliament and of the Council of 4 July 2012 on waste electrical and electronic equipment (WEEE). At the end of its life, please dispose of this device according to the valid legal requirements.

The device uses an environmentally and ozone-neutral cooling agent (see Technical Data).

Dispose of the refrigerant appropriately and according to the national regulations.

Trotec GmbH & Co. KG

Grebbener Str. 7
D-52525 Heinsberg

☎ +49 2452 962-400

☎ +49 2452 962-200

info@trotec.com

www.trotec.com